

TYPES OF BRIDGES

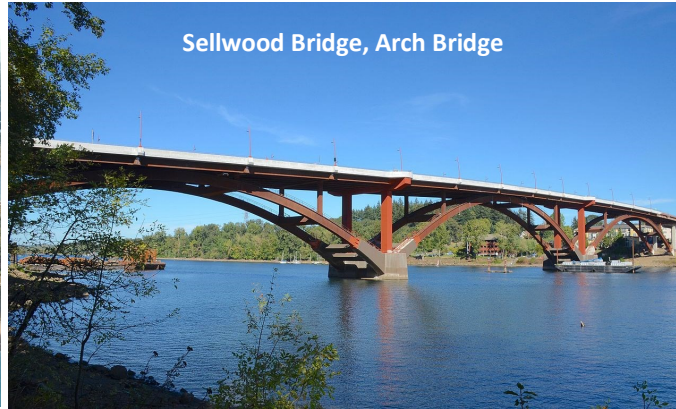

I-205 Bridge, Beam Bridge



Sellwood Bridge, Arch Bridge



Hawthorne Bridge, Truss Bridge

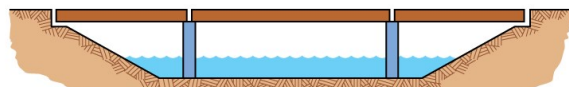

beam

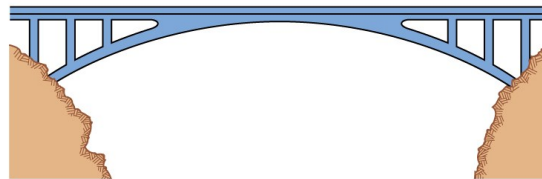

arch

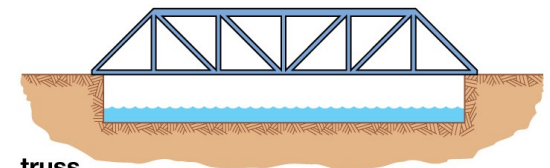

truss

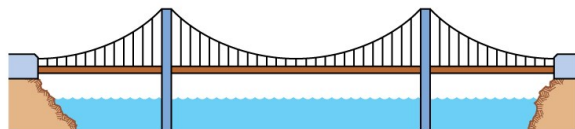

suspension

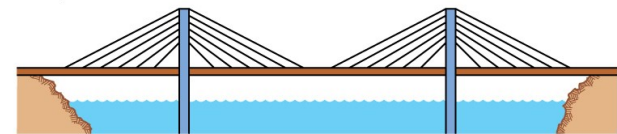

cable-stayed

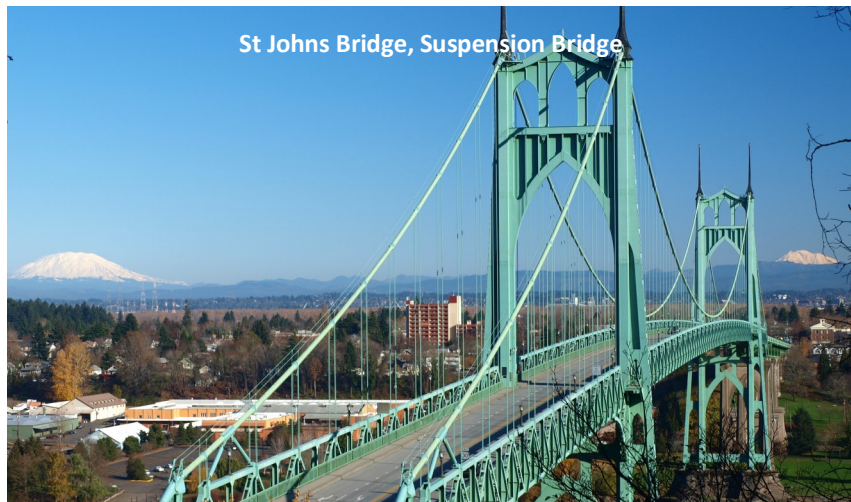

St Johns Bridge, Suspension Bridge



Tilikum Crossing, Cable Bridge

TRUSS BRIDGES

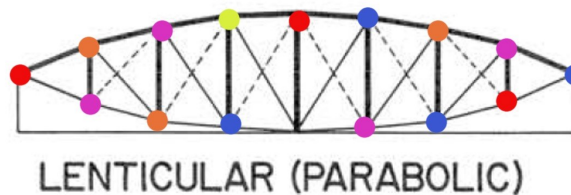
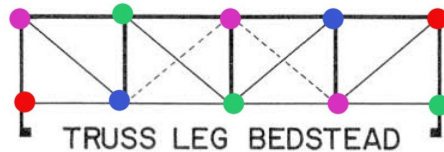
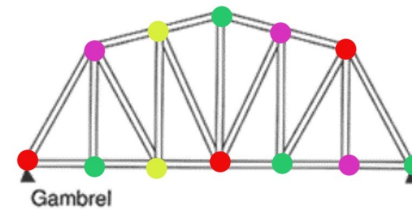
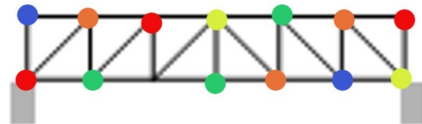
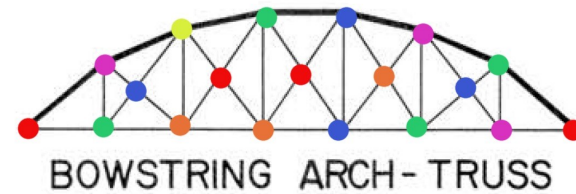
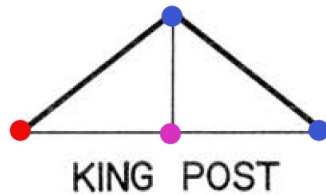
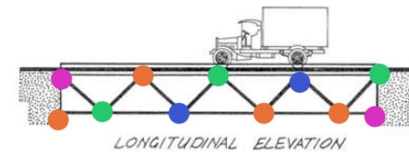

There are lots of different types of Truss Bridges! A truss is a design made of **triangles**. Triangles are one of the strongest shapes. Triangles distribute force equally, so that no point of the bridge has to support more weight than another.